



AN ESAB® BRAND

CHEM MASTER SGH600 SERIES

6.0 Purity Header Rail Assemblies

The Chem Master range of header rail assemblies and tailpipes are designed for use with corrosive, toxic and high purity gases up to grade 6.0 purity (99.9999%). They are intended for use in conjunction with our gas control panels integrated within gas management and distribution systems.

- **SGH610 Series** | Chem Master Universal Left Hand Header
- **SGH620 Series** | Chem Master Universal Right Hand Header

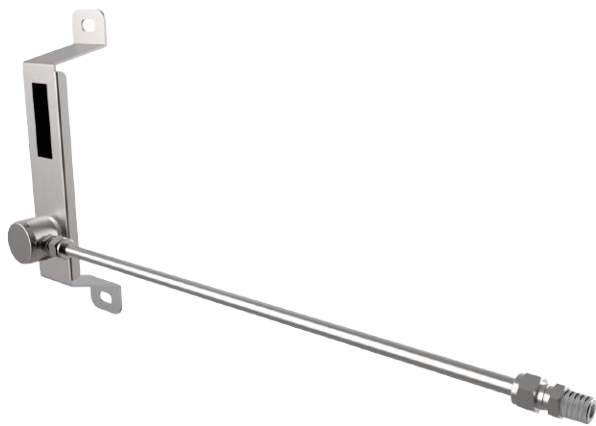

Left handed configuration shown

★ FEATURES

3 Inlet & 1 Outlet Ports

Left or Right Hand Configuration

Compression Style Connection

Supplied with 2 off 1/4" NPT Plugs

👍 SPECIFICATION

Maximum Inlet Pressure 300 bar (4350 PSI)

Ports 1/4" NPT Female

Temperature Range -20° C to +60° C (-4° F to +140° F)

Weight 0.60 kg (1.32 lbs) Maximum

📄 MATERIALS

Bracket Stainless Steel

Body Stainless Steel

Connecting Tube Stainless Steel

Connections Stainless Steel

Model No. Selector Guide

| Product Type | Inlet Pressure | Options |
|--------------|-----------------------|-----------------------------|
| SGH610 | 04 300 bar / 4350 PSI | A No Options Selected |
| SGH620 | | G Helium Test Certificate |
| | | K Certificate of Conformity |
| | | X Special Instruction |



DIMENSIONS

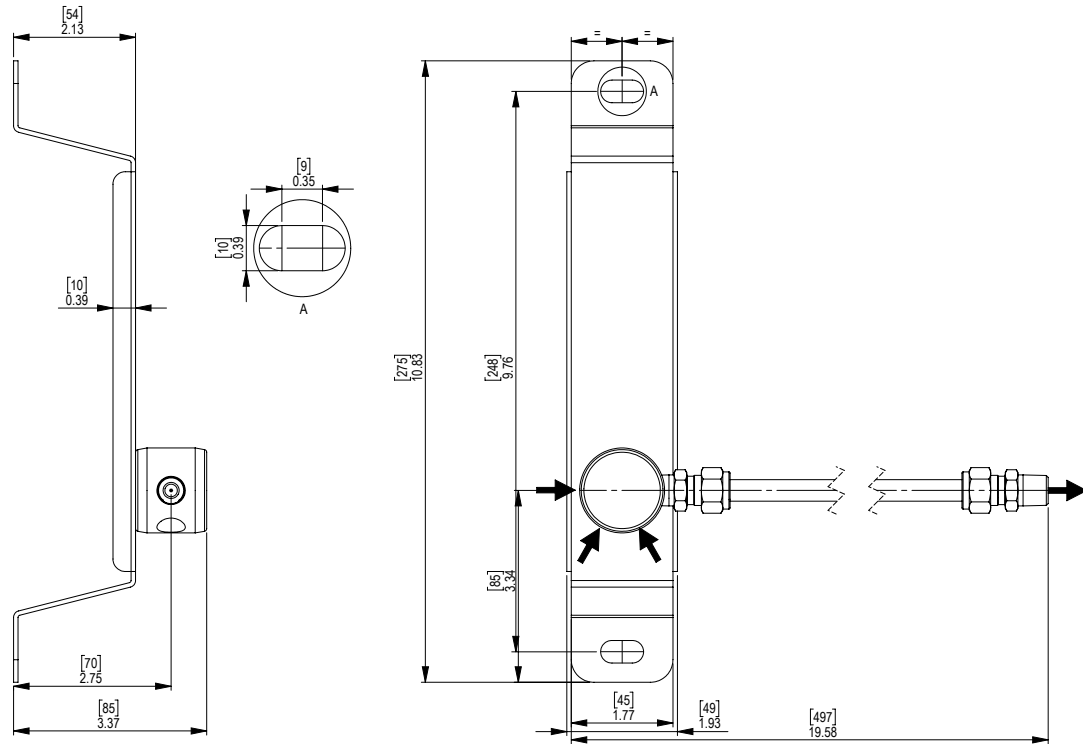

CONTROL PANEL WITH HEADER INSTALLATION GUIDE

Inches [mm]

